

BLOWER KIT 2302

INSTALLATION / OPERATING INSTRUCTIONS

THIS KIT IS FOR USE WITH MODELS:
2203621; 2203622; 3003621; 3003622; 3003621.05

IMPORTANT:
OIL YEARLY WITH SAE 20 HIGH TEMP OIL

WARNING

**DANGER OF PROPERTY DAMAGE
BODILY INJURY OR DEATH**

TURN OFF ELECTRIC POWER SUPPLY AT DISCONNECT SWITCH, FUSE BOX OR SERVICE PANEL BEFORE REMOVING OR WORKING ON FAN CABINET.

This accessory can be operated using the factory equipped three-prong (grounding) plug and cord or may be field wired. See field wiring installation instructions below. If using the factory equipped three-prong (grounding) plug it must be plugged directly into a properly grounded three-prong receptacle. **DO NOT CUT OR REMOVE THE PRONG.** All electrical work must conform to your local codes and ordinances or in their absence, with National Electrical Code ANSI/NFPA 70. In Canada, CANADIAN ELECTRICAL CODE C22.1. If you are not familiar with wiring codes in general, have a competent electrician do this job.

MOUNTING BLOWER ACCESSORY TO THE FURNACE

- STEP 1 Remove the knock-out plates "A" and "B" from right side of the furnace (see illustration below).
- STEP 2 Remove the junction box cover and place blower and junction box in position as shown.
- STEP 3 Attach the blower and junction box to the inner casing using the pre-punched holes with screws "C" and "D" provided with this kit. See illustration below for proper mounting hole to use with your furnace model (see rating plate for furnace model number). Reattach junction box cover.
- STEP 4 After blower and junction box are installed, rotate bushing "H" if needed to prevent motor wire from binding against blower case.
- STEP 4 Plug in factory supplied three-prong (grounding) plug and cord or see field wiring instructions below.

FIELD WIRING INSTALLATION INSTRUCTIONS

- STEP 1 Remove junction box cover and disconnect factory installed three-prong (grounding) plug and cord.
- STEP 2 Install 115V line in accordance with local codes, connecting as shown on the wiring diagram below.
- STEP 3 Reattach junction box cover.

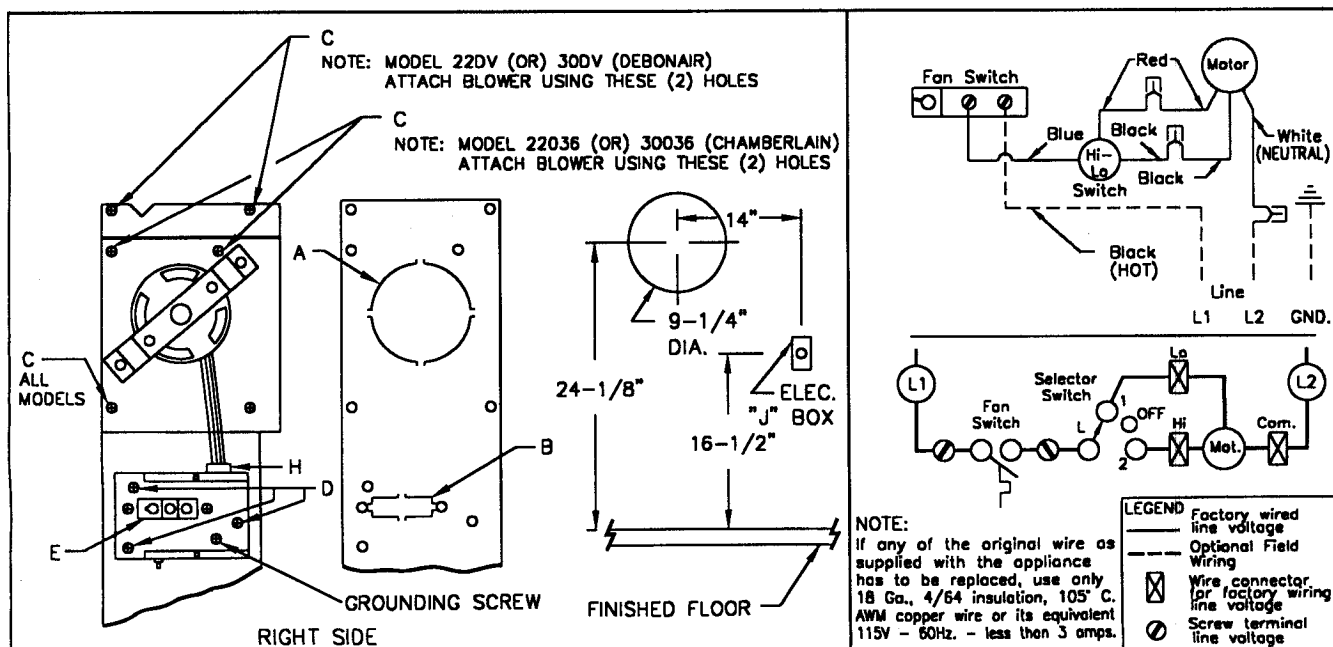

NOTE: Refer to your owner's manual for additional information and to be sure this accessory is of the type and design required for use with your furnace.

INSTALLATION / OPERATING INSTRUCTIONS CONTINUED:

BLOWER OPERATION (Refer to illustration on page 1)

The automatic fan switch turns on the blower after the furnace has been operating a few minutes and turns off the blower after the furnace shuts off. The blower will not operate unless the fan switch (pull chain) is pulled to the "ON" position, either "HIGH" or "LOW". To check the fan switch (pull chain) position, turn the automatic fan switch dial to 70, then pull the chain on the fan switch to obtain the high, low or off position. Set the automatic fan switch dial to 110 and readjust it higher or lower as necessary to obtain blower operation within 4 to 5 minutes after the furnace burner is in operation.

REPLACEMENT PARTS FOR BLOWER KIT 2302

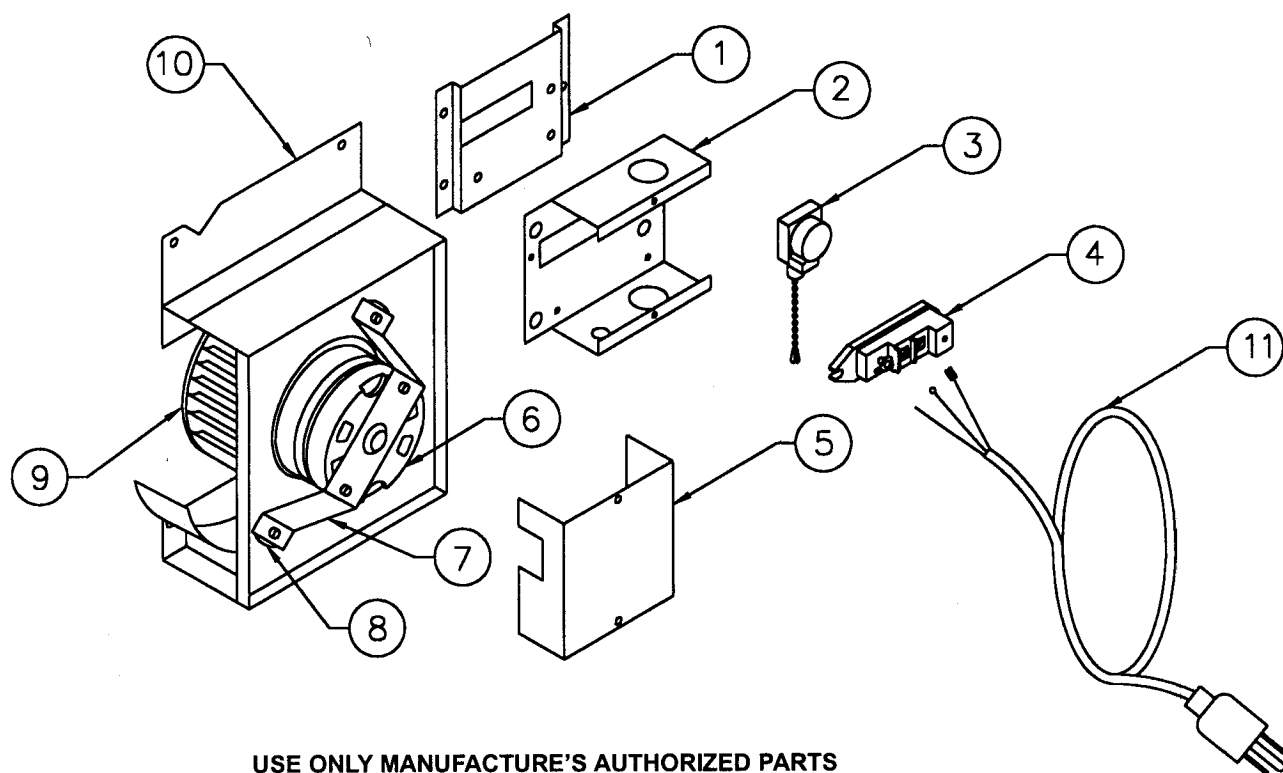

USE ONLY MANUFACTURE'S AUTHORIZED PARTS

REF. NUMBER	PART NUMBER	DESCRIPTION
1	6A24	SWITCH BRACKET
2	6B33	SWITCH BOX
3	P321017	FAN SWITCH (PULL CHAIN)
4	P129700	AUTOMATIC FAN SWITCH
5	6A23	SWITCH BOX COVER
6	P130600	MOTOR
7	6A93	MOTOR SUPPORT
8	P128400	VIBRATION ISOLATOR (2 REQUIRED)
9	P130700	BLOWER WHEEL
10	6B64	BLOWER FRAME
11	6B189	PLUG AND CORD

NOTE: SCREWS AND BOLTS ARE STANDARD HARDWARE ITEMS, AVAILABLE LOCALLY.

NOTE: Refer to your owner's manual for additional information and to be sure this accessory is of the type and design required for use with your furnace.