

Installation Instructions for VC-100,VC4,KMVC-100

Outdoor Vent Cap

Note: This vent cap is approved for use on outdoor installations only



Step 1: Locate and Remove Mounting Screws

The screws are located on the top of the heater as shown in figure 1. Remove the 2 outer screws.

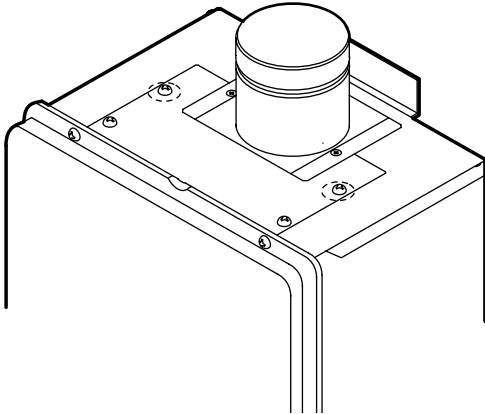

Figure 1: Location of mounting screws

Step 2: Install the Vent Cap

Locate the hole on the bottom of the vent cap. Slide the vent cap over the flue (with the louvers facing forward) as shown in figures 2a and 2b. The cap will rest on the top of the heater.

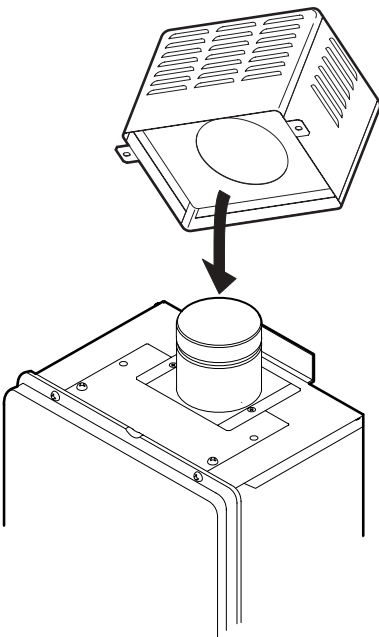

Figure 2a: Slide vent cap over flue.

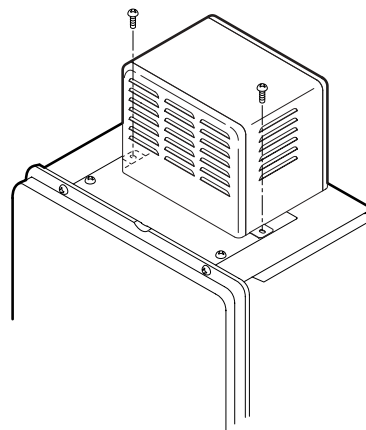

Figure 2b: Vent cap installed.

Step 3: Secure the Vent Cap

Secure the vent cap to the heater using the screws removed in step 1.