

## REU-V3237 Venting (ProTech Systems) Illustrated Parts List

Dimensions are in inches. The following are the ProTech vent parts available through Rinnai. (The air intake system consists of a field supplied 4 inch Schedule 40 PVC, ABS, or CPVC pipe. Cell core products are not authorized.)

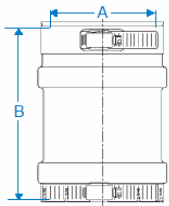

Universal Appliance Adapter		
A Vent Dia.	B Eff. Lgth	Part Number
4	5.3	FSAAU4SP

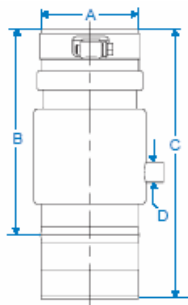

Universal Condensate Drain				
A Vent Dia.	B Eff. Lgth	C	D	Part Number
4	6.4	8.4	.63	FSUCD4SP

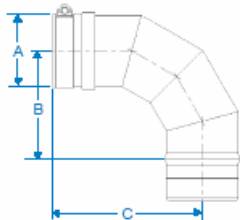

Elbow 90° 4"			
A Vent Dia.	B Eff. Lgth	C	Part Number
4	4.4	6.4	FSELB9004SP

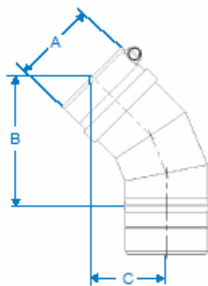

Elbow 45° 4"			
A Vent Dia.	B Eff. Lgth	C	Part Number
4	5.6	3.1	FSELB4504SP

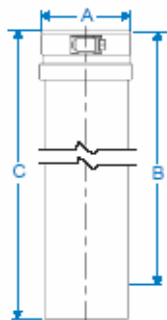

Adjustable Vent Length			
A Vent Dia.	B Eff. Lgth	C	Part Number
4	2-14	18	FSAVL4SP

All part renderings and drawings © ProTech Systems Inc.

## REU-V3237 Venting Illustrated Parts List

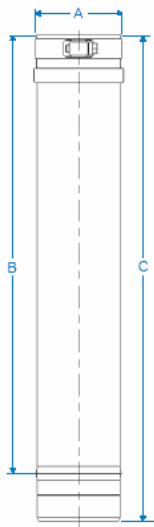

Vent Length			
A Vent Dia.	B Eff. Lgth	C	Part Number
4	10	12	FSVL1204SP
4	16	18	FSVL1804SP
4	22	24	FSVL2404SP
4	34	36	FSVL3604SP

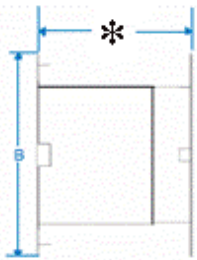

\* 4.25Min 8.50Max

Wall Pass Through (for internal walls only)		
A Vent Dia.	B	Part Number
4	10.0	FSWPT4SP

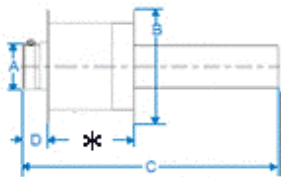

\* 4.25Min 8.50Max

Wall Thimble with Adjustable Vent Length (for external termination)				
A Vent Dia.	B	C	D	Part Number
4	10.0	18.0	2.0	FSWT4SP

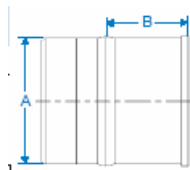

Bird Screen Assembly		
A Vent Dia.	B Eff. Lgth	Part Number
4	2.0	FSBS4SP

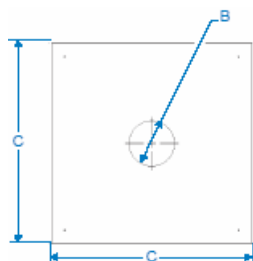

Fire Stop / Flat Flashing			
A Vent Dia.	B Diameter	C	Part Number
4	4.4	15	FSFS4SP

# REU-V3237 Venting Illustrated Parts List

## Variable Pitch Roof Flashing Kit

Part Number: FSVPK4



### Kit Components

- Rain Cap
- Storm Collar
- Roof Jack
- Roof Flashing

		<table border="1"> <thead> <tr> <th colspan="4">Rain Cap</th> </tr> <tr> <th>A Vent Dia.</th> <th>B</th> <th>C</th> <th>D</th> </tr> </thead> <tbody> <tr> <td>4</td> <td>4.5</td> <td>8.9</td> <td>1.0</td> </tr> </tbody> </table>	Rain Cap				A Vent Dia.	B	C	D	4	4.5	8.9	1.0
Rain Cap														
A Vent Dia.	B	C	D											
4	4.5	8.9	1.0											
		<table border="1"> <thead> <tr> <th colspan="2">Storm Collar</th> </tr> <tr> <th>A Vent Dia.</th> <th>B</th> </tr> </thead> <tbody> <tr> <td>4</td> <td>4.0</td> </tr> </tbody> </table>	Storm Collar		A Vent Dia.	B	4	4.0						
Storm Collar														
A Vent Dia.	B													
4	4.0													
		<table border="1"> <thead> <tr> <th colspan="3">Roof Jack (use with Variable Pitch Roof Flashing)</th> </tr> <tr> <th>A Vent Dia.</th> <th>B</th> <th>C</th> </tr> </thead> <tbody> <tr> <td>4</td> <td>5.0</td> <td>18.0</td> </tr> </tbody> </table>	Roof Jack (use with Variable Pitch Roof Flashing)			A Vent Dia.	B	C	4	5.0	18.0			
Roof Jack (use with Variable Pitch Roof Flashing)														
A Vent Dia.	B	C												
4	5.0	18.0												
		<table border="1"> <thead> <tr> <th colspan="3">Variable Pitch Roof Flashing (flat - 9/12 pitch)</th> </tr> <tr> <th>A Vent Dia.</th> <th>B</th> <th>C</th> </tr> </thead> <tbody> <tr> <td>4</td> <td>6.0</td> <td>7.0</td> </tr> </tbody> </table>	Variable Pitch Roof Flashing (flat - 9/12 pitch)			A Vent Dia.	B	C	4	6.0	7.0			
Variable Pitch Roof Flashing (flat - 9/12 pitch)														
A Vent Dia.	B	C												
4	6.0	7.0												

## REU-V3237 Venting Illustrated Parts List

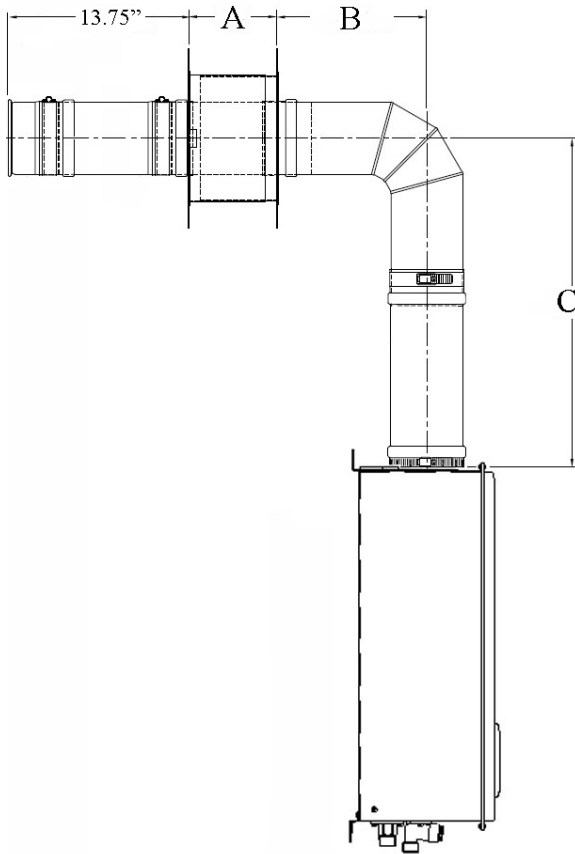

Wall Mount Kit with Birdscreen Termination 4" (Rinnai 3237 Kit)			
A	B	C	Part Number
8.38 - 4.38	13.25 - 9.5	18.25-14.25	FSWMKBS4

### Kit Components

- Bird Screen Assembly
- Wall Thimble (8.38" - 4.38")
- Telescoping Horizontal Length (13.25" - 9.5")
- Adjustable Vertical Length (18.25" - 14.25")
- Universal Appliance Adapter
- 12" Vent Length

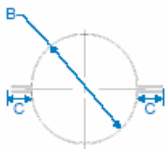

Support Clamp			
A	B	C	Part Number
Vent Dia.	Diameter		
4	4.0	1.5	FSCL4SP