

# High-Efficiency WILLIAMS Direct-Vent Furnaces

A high-efficiency, low-profile furnace with attractive styling that may be installed nearly anywhere. Great for homes, apartments, offices, garages and room additions.



**29,000 Btu/hr.**



**7,400 Btu/hr.**

Just minutes are needed to warm up your room while enjoying the money-saving, high-efficiency design, modern appearance and low-cost installation.

Williams' high-efficiency direct-vent furnaces require no inside air for operation, making them an ideal choice for safe operation to add comfort to nearly anyplace heat is needed.

## Design Features

- ✓ Efficiency Ratings:
  - 7,400 Btu/hr. Series: 72% Thermal Efficiency
  - 17,700 and 29,000 Btu/hr. Series: 82% Thermal Efficiency
- ✓ Natural and propane gas models
- ✓ Easy installation - all vent material included
- ✓ Attractive, durable fresh-white finish
- ✓ Unique wall-mount design requires no floor space
- ✓ Small, low profile vent size
- ✓ Sealed-combustion safety technology uses no inside room air
- ✓ Air-to air system offers instant heat



**17,700 Btu/hr.**

# High-Efficiency Direct-Vent Furnaces

Model Number	Btu/hr. Input Rating	Btu/hr. Output Rating	Efficiency Percentage		Dimensions			Maximum Wall Thickness	Air Flow (cfm)	Type of Control	Electrical Supply	Total Electrical Load	Shipping Weight (lbs.)
			Thermal	AFUE	Width	Depth	Height						
Natural													
0743512	7,400	5,400	73	72	18½"	6¾"	22¾"	19½"	—	Built-In	—	—	44
1773512	17,700	14,000	82	81	21¾"	8¼"	28½"	19½"	125	Built-In	110 Volts	86	57
2903512	29,000	23,780	82	81	39½"	8¼"	28½"	19½"	260	Built-In	110 Volts	140	93
Propane													
0743511	7,400	5,600	76	72	18½"	6¾"	22¾"	19½"	—	Built-In	—	—	44
1773511	17,700	14,500	82	81	21¾"	8¼"	28½"	19½"	125	Built-In	110 Volts	86	57
2903511	29,000	23,780	82	81	39½"	8¼"	28½"	19½"	260	Built-In	110 Volts	140	93

All models are rated for 2,000 feet elevation and may be derated. Not recommended for installations above 5,000 feet.

## Features

### Unique Wall-Mount Design

Furnaces require no floor space.

### Electronic Ignition

Assures convenient pilot lighting without matches.

### Requires No Electricity - (0743511 and 0743512 Models)

## Dimensions and Clearances

### Models 0743511 and 0743512

- 2" to an intersecting wall.
- 10" from the top of the furnace to the ceiling or overhang.
- $\frac{1}{4}$ " to the back wall (0" to spacers).
- 2" to finished floor.
- 4 $\frac{1}{8}$ " Wall hole diameter.
- 3 $\frac{7}{8}$ " Air inlet pipe diameter.
- 2 $\frac{1}{2}$ " Exhaust pipe diameter.

### Models 1773511, 1773512, 2903511 and 2903512

- 3 $\frac{3}{8}$ " to an intersecting wall.
- 10" from the top of the furnace to the ceiling or overhang.
- 0" to the back wall.
- 2" to finished floor.
- 2" Wall hole diameter.
- 1 $\frac{7}{8}$ " Air inlet pipe diameter.
- 1 $\frac{1}{2}$ " Exhaust pipe diameter.

## Accessories



Umbrella Holder  
P332533



Fragrance Holder  
P332532



Towel Warmer  
P332530



Warming Tray  
P332531

## Models 1773511 and 1773512 Accessories

### Models 1773511, 1773512, 2903511 and 2903512



#### Programmable Timer

A programmable thermostat in your home is one of the easiest ways to save energy and money. On/Off, seven-day timer/clock.



#### Humidification System

Relieves the effects of dry air. Built-in humidifier keeps air soft and moist in dry weather.



#### Summertime Ventilation

A two-speed recirculating fan will move the cool air off the floor and circulate it throughout your home, keeping it more comfortable.

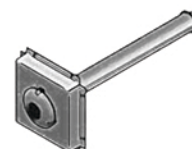

#### Vent Adapter

The Vent Adapter Accessory is used to compensate for the extra space left around the vent hole when replacing a furnace with a larger vent opening. It can also be used to extend the flue terminal on homes with vinyl siding so that the vent cap lies flush against the edge of the siding.

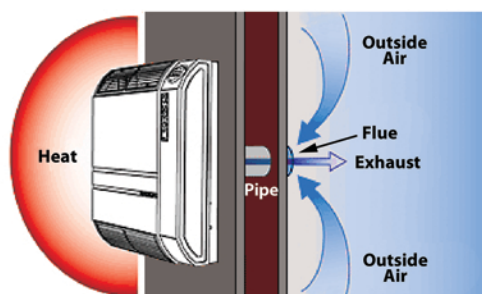

## Direct-Vent Safety

For clean, comfortable heat when and where you want it. The gas flame is completely sealed inside, away from all contact with room air. Air necessary for combustion is drawn into the chamber from outside through the vent, and combustion products are vented directly to the outside. Only clean, gentle heat, in continuous circulation is delivered into the room. Windows and doors stay closed because no room air is used for combustion.

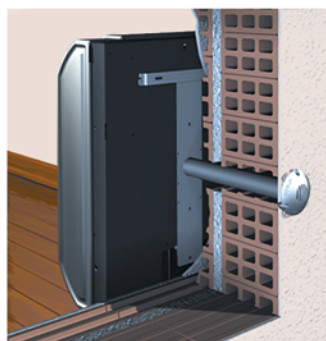

#### Termination Cap (flue)

Small, low-profile termination cap goes on the exterior of the building.



Scan for more  
information on  
Williams' products



**WILLIAMS**

250 West Laurel Street · Colton, California 92324 USA  
(909) 825-0993 · Fax: (909) 370-0581 or (909) 824-8009  
Consumer Line: (888) 256-6465  
Homeowner Assistance: (909) 426-0978  
www.e-wfc.com

## Important

- Read owner's manual before using/installing.
- Photographs are representative.
- Check local codes and ordinances for permitted uses.
- Consult installation manual for clearances prior to installation.
- We reserve the right to amend product specifications without notice.
- Installation and servicing recommended by a qualified service person.
- Venting must comply with the installation manual.
- Massachusetts approval G3-0212-385.
- Please read the warranty for any limitations or disclaimers.
- Combustion chamber carries a ten-year limited warranty. All other parts carry a one-year limited warranty.