

AQ25142B Boiler Reset Zone Synchronizing Control Panel

System commissioning date: _____

Customer: _____

Building address: _____

INSTALLATION JOB RECORD

INSTRUCTIONS:

Fill in the details of the equipment connected to the control module and the zoning module:

- A** Low voltage control module wiring
- B** Low voltage zone thermostats
- C** Line voltage zone pumps or low voltage zone valves without end switches
- D** Line voltage Boiler pump, DHW pump and AUX output
- E** Review and set DIP switch settings - once DIP switches for the zoning module (AQ15540B) have been set, complete the "Installer Settings" diagram by filling in the circles to indicate the DIP switch position set during installation

File this with other installation records for equipment used on this installation.

A Boiler Control Module

Terminal #	9-10	13-14	17-18	19-20
Terminal ID	Aux. In	DHW	Boiler	Aux. Out
Function	Installer defined	DHW demand	Boiler demand	Installer defined
Equipment				
Manufacturer				
Model #				
Serial #				
Date Code				
Notes				

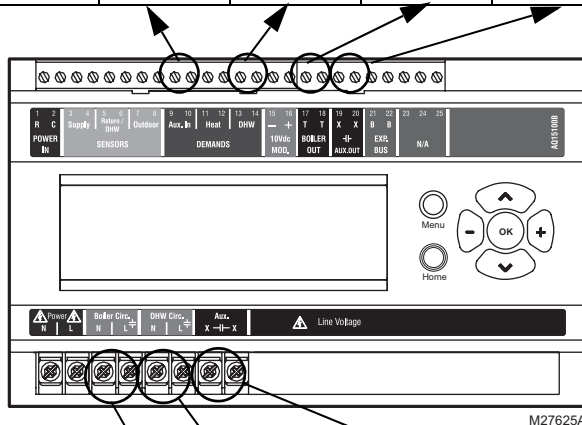

B Zoning Thermostats

Terminal #	5-6	7-8	9-10	11-12
Terminal ID	TH1	TH2	TH3	TH4
Function	Zone call for heat			
Equipment				
Manufacturer				
Model #				
Date Code				
Notes				

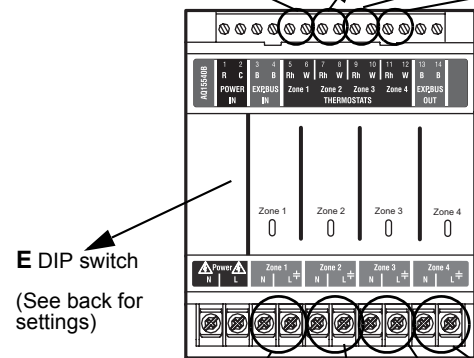

C Boiler Pump, DHW, and AUX Device

Terminal ID	Boiler	DHW	Aux
Function	Boiler loop control	DHW loop control	Line voltage-rated Aux. device control (installer-defined)
Equipment			
Manufacturer			
Model #			
Power (Amps)			
Notes			

D Zoning Pumps or Valves

Terminal ID	Zone 1	Zone 2	Zone 3	Zone 4
Function	Zone control			
Equipment (circle one)	Pump / Valve	Pump / Valve	Pump / Valve	Pump / Valve
Manufacturer				
Model #				
Date Code				
Power draw Amps (pumps) VA (valves)				
Notes				



E Zoning Module DIP Switch Settings

DIP Switch	Switch Description
1 2 3 4	<p>Zone Address: The positions of these 4 DIP switches define the unique address for each zone on the AQUATROL network. For each group of 4 zones, there can be only one DIP switch in the right-hand (ON) position.</p> <p>The correct DIP switch settings for each zone module are:</p> <ul style="list-style-type: none">First Zone (1-4) Module: 1 = ON position; 2, 3, and 4 = OFF positionSecond Zone (5-8) Module: 2 = ON position; 1, 3, and 4 = OFF positionThird Zone (9-12) Module: 3 = ON position; 1, 2, and 4 = OFF positionFourth Zone (13-16) Module: 4 = ON position; 1, 2, and 3 = OFF position
5	<ul style="list-style-type: none">If set to SYNC, zone synchronization is enabled.If set to NOT, zone synchronization is disabled.
6	<ul style="list-style-type: none">If zone valves are normally closed (N.C.), set the NC/NO DIP switch to the OFF position.If zone valves are normally open (N.O.), set the NC/NO DIP switch to the ON position.
7	<ul style="list-style-type: none">If set to Group (ON position), the AUX Pump contacts on the Control Module are switched when any of the zones on this Zoning Module are active.If set to - (OFF position), the AUX Pump contacts are not affected by activity on these zones.
8	<ul style="list-style-type: none">If set to 2-Stg (ON position), then 2-stage operation is activated on thermostat inputs. The zoning module operates as two 2-stage zones or 3 zones (one 2-stage and two 1-stage).If set to 1-Stg (OFF position), then operates as four 1-stage zones.

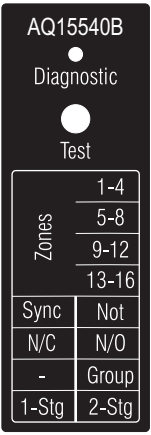

M23720A

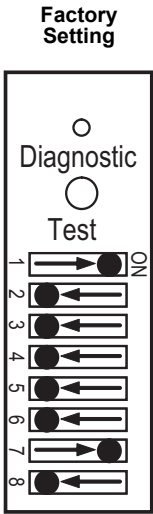

M27696

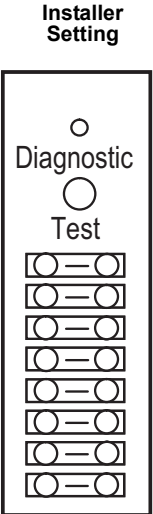

M23715

Fill in the circle to indicate position of DIP switch.

EQUIPMENT SETTINGS

The Installer Menu is used to establish and modify the system's equipment and option settings. These include equipment settings for boiler operation, DHW management, zoning, auxiliary input/output operation, and option settings such as pump/valve exercise, and freeze protection.

Use Table 1 to record the equipment settings for this installation.

To record the equipment and option settings:

- A** Press the Home button to return to the Home Page display.
- B** Press and hold the OK button for 3 seconds until the message, INSTALLER MODE – ARE YOU SURE?, displays.
- C** Select YES, then press and release the OK button to display the Installer Menu.
- D** Select the Equipment Setup sub-menu.
- E** Record the configured settings in Table 1.
- F** Exit Installer mode by selecting the Installer Exit menu option.

Table 1. Installer Menu – Equipment Setup Sub-menu.

EQUIPMENT SETUP SUB-MENU				
Sub-Menu and Option		Range	Factory Default	Equipment Settings Used
BOILER SETTINGS				
	HIGH LIMIT	120°F to 225°F (49°C to 107°C)	190°F (88°C)	
	LOW LIMIT	60°F to 180°F (15°C to 82°C)	150°F	
	BOILER DIFF	2°F to 41°F (1°C to 23°C) / AUTO	AUTO	
	W.W.S.D.	-- ^a 35°F to 100°F (2°C to 38°C)	70 °F (21°C)	
	RESET	OUTDOOR / LOAD / NONE	OUTDOOR	
	OUTDOOR LOW	-60°F to 32°F (-51°C to 0°C)	10 °F (-12°C)	
	BOILER DSGN	80°F to 210°F (27°C to 99°C)	180°F (82°C)	
	MIN. RETURN	OFF / 80°F to 180°F (27°C to 82°C)	140 °F (60°C)	
BOILER OPERATION				
	CYCLES/HOUR	2 to 6	4	
	FIRE DELAY	0 seconds to 3 minutes (in 5 second increments)	10 seconds	
	PURGE TIME	OFF / 10 seconds to 30 minutes (in 10 second increments)	30 seconds	
	EXERCISE	YES / NO	YES	
	FREEZE PROT	YES / NO	YES	
10V MOD. SELECT				
	10V MOD	0-10V / 2-10V	0-10V	
	USAGE	NONE / BOILER	NONE	
DOMEST. HOT WATER				
	DHW	ENABLE / DISABLE	ENABLE	
	DHW PRIO	YES / NO	NO	
	PRIO.OVER.	YES / NO	YES	
	DHW DEVICE	PUMP / VALVE	PUMP	
	DHW VLV.OP	0 - 230 seconds (in 5 second increments)	15 (seconds)	
	DHW PURGE	YES / NO	YES	
	DHW SENSOR	YES / NO	NO	
	DHW SETPOINT	-- 60°F to 160°F (16°C to 71°C)	140°F (60°C)	
	DHW DIFF	-- 5°F to 40°F (2.5°C to 22°C)	20°F (-7°C)	
	DHW VACANCY	-- [41°F + DHW DIFF] to 160°F ([5°C + DHW DIFF] to 71°C)	45°F (7°C)	
ZONING				
	HT DMND PRIO	YES / NO	NO	
	PRIO.OVER	YES / NO	NO	

Table 1. Installer Menu – Equipment Setup Sub-menu. (Continued)

EQUIPMENT SETUP SUB-MENU				
Sub-Menu and Option		Range	Factory Default	Equipment Settings Used
ZONING VALVES TIME TO OPEN		5 - 230 seconds	15 seconds	
AUXILIARY I/O				
AUX.IN (optional)		SETBACK / VACATION / EM. SHUT / NONE	SETBACK	
AUX.OUT (optional)		BOILER / SETBACK / ZONE OP. / ALARM / AUX.IN / DHW IN / HEAT IN / HT DMND / NONE	BOILER	
AUX.PUMP (optional)		BOILER / GROUP / OCC / BYPASS / NONE / AUX.IN / DHW IN / HEAT IN / HT DMND	BOILER	
A/C SETTINGS				
CYCLES/HOUR		2 / 3 / 4 / 5 / 6	4	
MIN.OFF TIME		2 to 10 (minutes)	5M	
C.W.S.D.		-- 32°F to 100°F (0°C to 38°C)	65°F (18°C)	
A/C EQUIP. CONFIG				
ZONE		A-1 to D-16	A-1	
A/C UNIT		NONE / 1	1	
COOLING		ENABLE / DISABLE	ENABLE	
ENVIRACOM (not used at this time - reserved for future use)				
Modules ID:		n/a	n/a	

^a Any entry of two dashes (- -) indicates that the option is disabled or not used.

Automation and Control Solutions

Honeywell International Inc.
1985 Douglas Drive North
Golden Valley, MN 55422
customer.honeywell.com

Honeywell Limited-Honeywell Limitée
35 Dynamic Drive
Toronto, Ontario M1V 4Z9

Honeywell

